

# BORAL Shaftliner

BORAL Shaftliner is developed for use in Boral Shaft Liner Cavity Wall system to provide fire protection for elevator shafts, vertical ducts and other applications, when installation is possible from one side only. BORAL Shaftliner is manufactured in 600mm width and recognised by its blue/grey liner paper.

## Product Data

Thickness	Metric (mm)	25mm
Edge Details:	Bevelled Edge	Yes
Width (mm):	600	
Length (mm):	3600	
Weight:	25mm = 20.50kg/m <sup>2</sup>	
Product Standard:	BS 1230 part 1, ASTM C442	
Product Testing:	BS 476 part 4 / part 6 / part 7, ASTM C473	

• Boral Plasterboard are able to produce shorter lengths on request and depending upon order size.

**Figure 1: BORAL Shaftwall System - Perspective View (2 Hour Fire Rated)**

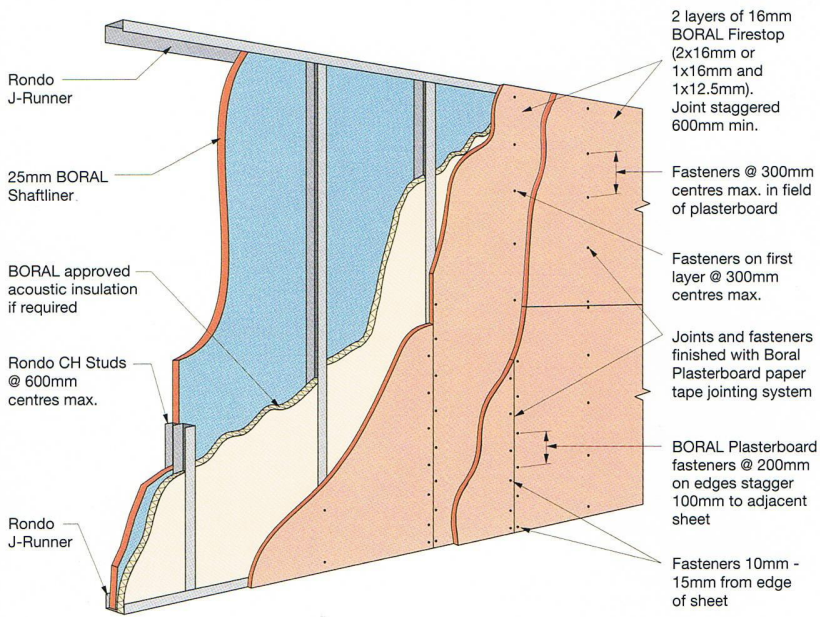

**Figure 2: BORAL Shaftliner Perimeter to Concrete or Masonry Wall (2 Hour Fire Rated)**

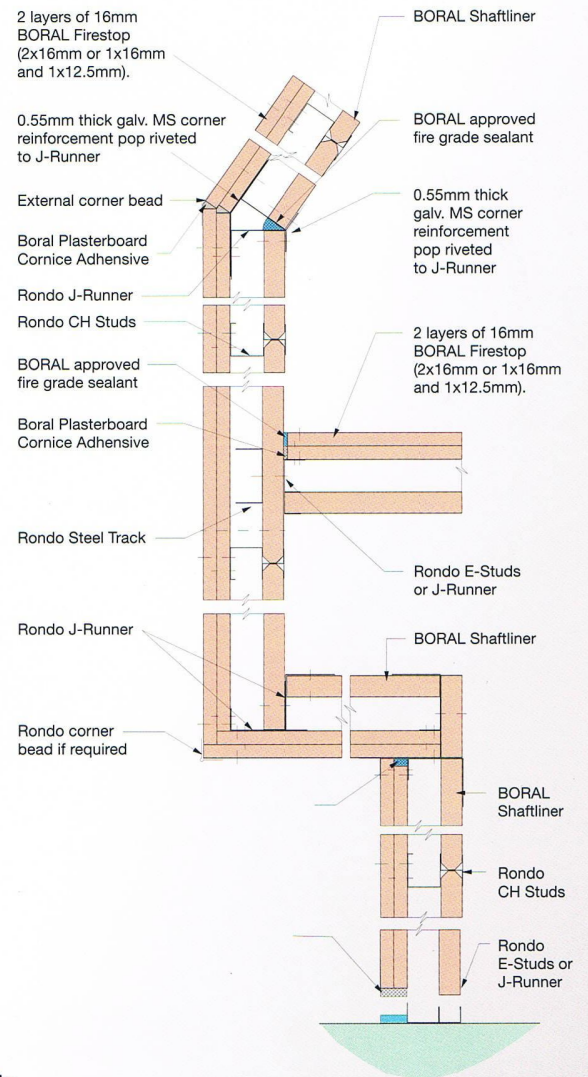

## How to specify this product:

Supply and install BORAL Shaftliner 25mm as shown on the relevant drawings. BORAL Shaftliner must be installed and finished in accordance to manufacturer's specification. For more information, please contact our technical service.

### Guarantee :

Boral Plasterboard warrants all goods manufactured and supplied when handled correctly and installed using the components and accessories specified in accordance with the instructions detailed in Boral Plasterboard Technical Literature.

\* Kindly refer to Boral Warranty certificate for limits of warranty.

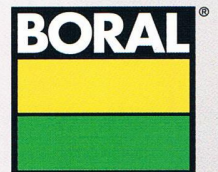

Boral Plasterboard (Malaysia) Sdn Bhd

**BORAL Shaftliner**  
Build something great™

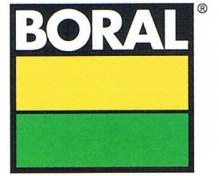

# Shaftliner

Installation Advantages and Cost Effective

BORAL Shaftliner is an appropriate product to be used when concealing lift shaft openings. This system has a number of benefit such as of one side installation, lightweight dry construction, quick installation, cost effective and able to provide fire resistance of up to 2 hours.

