

# PRODUCT INFORMATION

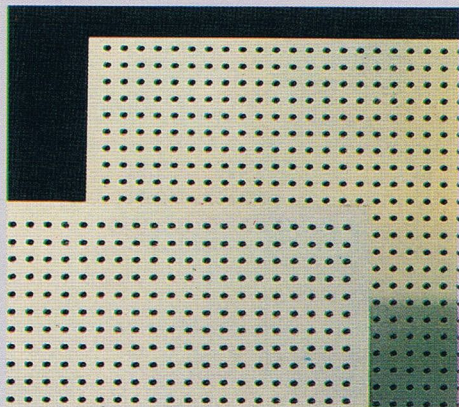

**BORAL PLASTERBOARD ACOUSTICAL** panels are lay-in type ceiling panels to be used on exposed suspended ceiling grids. The panels are also suitable for internal wall linings. The panels have a surface finished in proprietary white emulsion paint specially formulated for maximum protection and good light reflectance properties.

## SIMPLE INSTALLATION

Precision manufacture ensures that the panels are simply placed in a lay-in type ceiling grid system. Ducting, lighting and other fixtures can be easily integrated into the ceiling due to the easy workability of the panels. For wall applications, longer panels are available on request.

The panels are virtually maintenance-free, cost of upkeep being greatly reduced because the panels high-durability surface enable dirt smudges to be removed simply with a damp cloth. Over-painting does not affect the panels acoustical properties.

## STABILITY

Stringent quality control during manufacture and the use of the best materials ensure that the panels remain stable and warp-free for a long time when subjected to the normal range of ambient temperatures and humidity. As well, the high strength paper facings ensure that the panels stay flat and even.

## FIRE PERFORMANCE

The panels' gypsum core constitutes an effective barrier against fire. The core is non-combustible and, when exposed to flame, gradually releases water of crystallization as steam, thus retarding heat transfer. **BORAL PLASTERBOARD ACOUSTICAL** panels have an index of performance (I) not exceeding 12, and sub-index (i) not exceeding 6 when tested to BS476. Part 6 (1989).

## FLEXIBILITY

The panels are suitable for both ceiling and wall lining applications. For walls, panels of 2ft width and lengths of up to 8 feet size are available for simple and quick installation. Joints could be featured, flushed or exposed to achieve different visual effects. It is recommended that an airspace be created between panel and solid wall to achieve better sound absorption.

## ACOUSTICAL PROPERTY

The panels have been designed to combine the characteristics of both panel and resonator absorber and offers good sound absorption over a range of low to middle frequencies. Sound-absorbing performance at high frequencies can be improved by adding at the back a layer of porous absorbing material such as rockwool or fibreglass.

## COLOUR SELECTION

A wide range of colour options is available to complement every interior. Besides regular white, factory-coated colours to customer specifications are available on request. The panels can also be painted on-site.

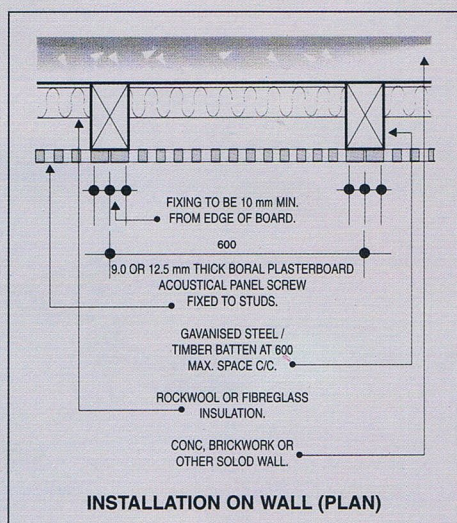
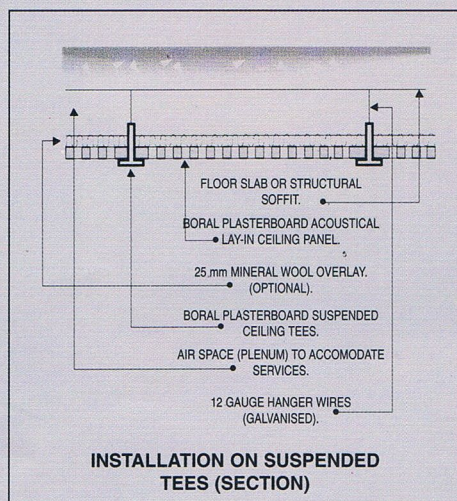

## PRODUCT DATA

Thickness	9.0mm, 12.5mm
Edge Detail	Square Edge
Suspension System	Exposed
Panel Sizes (imperial/metric)	2' x 2' / 600mm x 600mm 2' x 4' / 600mm x 1200mm 2' x 8' / 600mm x 2400mm
Weight	6.5kg/sq.m or 1.33lbs/sq.ft. (12.5mm) 4.9kg/sq.m or 1.00lbs/sq.ft. (9.0mm)

## SPECIFICATION

To supply and install 9.0mm thick fully perforated **BORAL PLASTERBOARD ACOUSTICAL** panel sizes (2 ft x 2 ft or 2 ft x 4 ft) on exposed galvanized grids system secured suspended 4ft from concrete soffit or steel purlin by means of 14 gauge galvanized wire. Wall mouldings shall be of galvanized angles securely plugged or secured to perimeters of the wall.



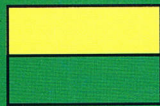

## **BORAL PLASTERBOARD** for a professional finish



## **A C O U S T I C A L**

**BORAL PLASTERBOARD ACOUSTICAL** ceiling panels have been specifically created as an alternative to traditional sound-absorbing materials, with the added advantage of being stronger, more durable and versatile. Made from **BORAL PLASTERBOARD**, these non-combustible and sag-free panels provide effective sound absorption for noise level control as well as to enhance architectural and decorative finishes.

With excellent sound absorption capability over a range of low to middle frequencies, the panels help reduce unwanted reflective sound, thus keeping background noise down to a level that ensures a congenial living and working environment. As well, the panels serve to regulate reverberance within an enclosed space. This makes them the ideal ceiling and wall material for department stores, office complexes, auditoriums, lecture hall and music rooms.

**BORAL PLASTERBOARD ACOUSTICAL** ceiling panels are manufactured from natural gypsum, a non-toxic material, under stringent JIS requirements. Specially reinforced gypsum core are used together with selected plasterboard liner to provide effective resistance against sag and deflection. The size and spacing of the perforations are precisely calculated to produce the desired sound-absorbing properties besides providing an attractive pattern. The result is a ceiling panel which offers a dramatic reduction in sound reflection as well as the pleasing appearance, superb finish and high flexibility of use traditionally associated with **BORAL PLASTERBOARD** ceiling panels.

**BORAL PLASTERBOARD** guarantees that its **ACOUSTICAL** ceiling panels fall within the finest tolerances of dimension and angle variance to fit ceiling grids perfectly. Custom