

BORAL SoundBlock
Build something great™

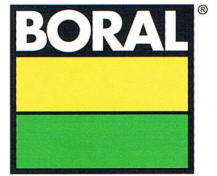

SoundBlock

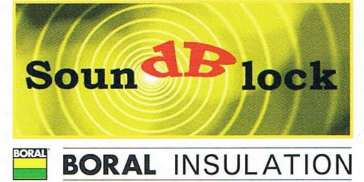

Effective Sound Absorption



LaSalle School of Arts, Singapore

BORAL SoundBlock

BORAL SoundBlock is a lightweight, flexible and durable insulation material, made of long glasswool bonded fibers with a thermosetting resin. BORAL SoundBlock is manufactured as an effective acoustical, sound absorption material, which also provides excellent thermal insulation qualities. Effective sound insulation is an essential requirement for modern lifestyles. Excessive noise can increase stress, hinder speech and can cause its own form of environmental pollution.

BORAL SoundBlock is specifically designed for application in plasterboard ceilings and partitions to help improve acoustic and fire resistance performance levels. BORAL SoundBlock is available in blanket form in various dimension.



Where is BORAL SoundBlock Used?

BORAL SoundBlock is used in lightweight metal studs partition and ceiling systems. It is an ideal material used for sound insulation in areas where sound absorption is crucial, such as offices, hotel lobbies, cinemas, auditoriums, etc.

Product Data

Thickness	50mm	
Density:	14 kg/m ³	16 kg/m ³
Blanket Dimension:	610mm x 15000mm 1220mm x 15000mm	
Non-Combustibility Test:	BS 476 Part 4:1970	
Acoustic Test:	PSB No. 54S073678/B/EMK	

How is BORAL SoundBlock Installed?

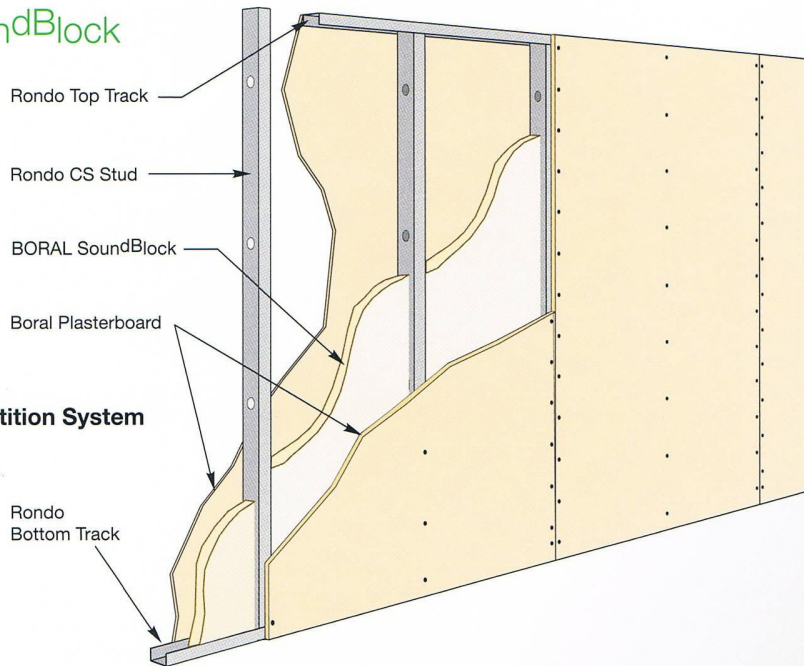

BORAL Standard Wall/Partition System
(STC: 45 - 72)

BORAL Echostop Ceiling System

